



**Lone Star Executive Airport KCXO**  
Gateway to The Woodlands and North Houston

## Gateway to The Woodlands and North Houston

Uniquely positioned as a gateway to North Houston, the Lone Star Executive Airport in Conroe is located only 25 minutes from The Woodlands.

Among many advantages, the Lone Star Executive Airport offers convenient taxi routes to all runway ends with no landing fees.

The airport features two runways ideal for large cabin jets:

- Runway 14-32: 6,000-foot by 150-foot wide, full ILS with approach lighting.
- Runway 1-19: 5,000-foot by 100-foot LPV/GPS/RNAV instrument approaches.

Near future expansion plans include the extension of the Runway 14-32 to 7,500-feet.

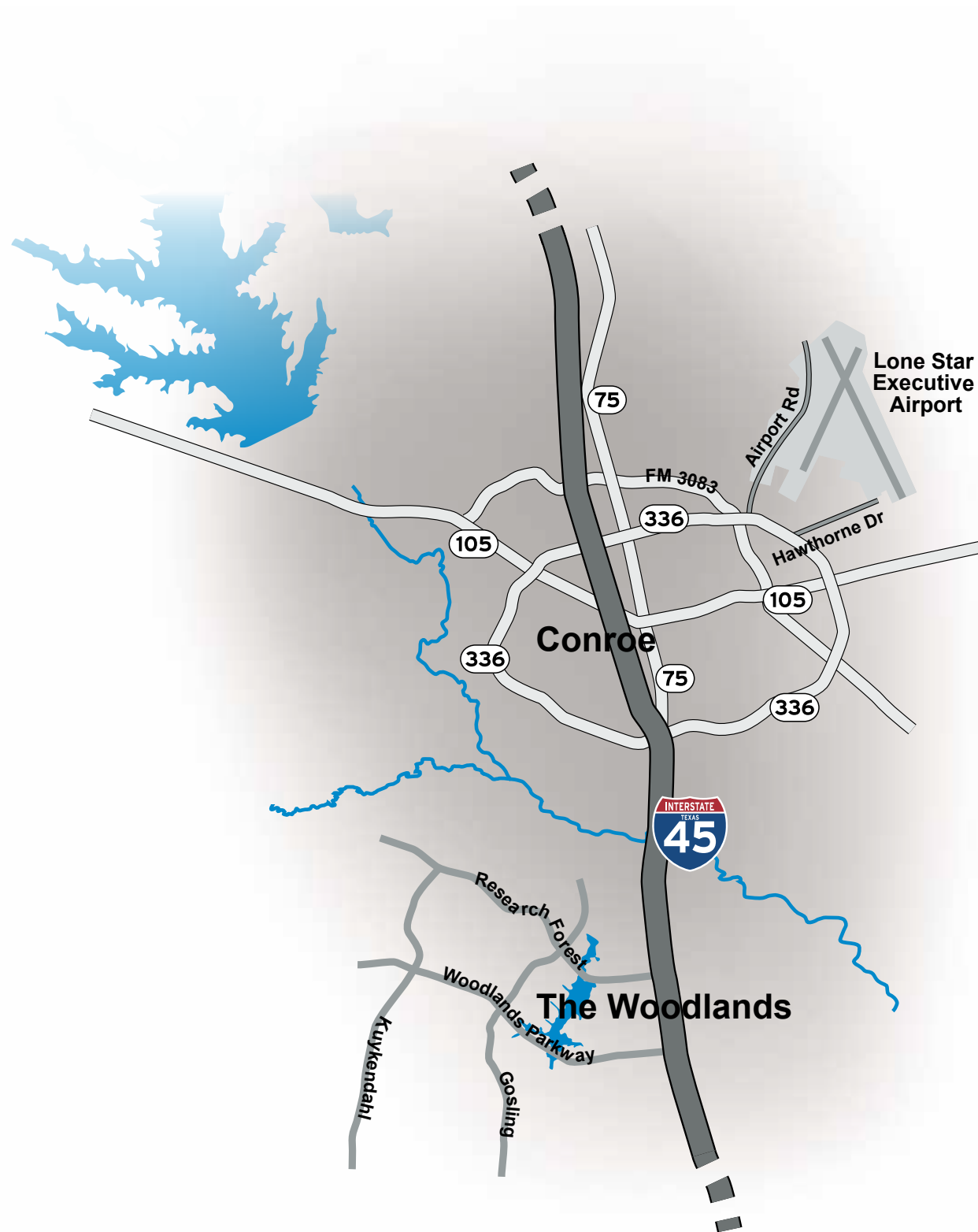



Houston Airports	Distance to The Woodlands	ILS Approach Runway	Runway Over 5,000 ft	Commercial Airline Traffic	U.S. Customs
Lone Star Executive	25 Minutes	Available	Multiple	None	Coming Soon
George Bush Intercontinental	25 Minutes	Available	Multiple	Heavy	Available
David Wayne Hooks Memorial	25 Minutes	N/A	1	None	N/A
William P. Hobby	50 Minutes	Available	Multiple	Heavy	Available
West Houston Airport	50 Minutes	N/A	N/A	None	N/A
Sugar Land Regional Airport	70 Minutes	N/A	1	None	Available
Houston Executive Airport	70 Minutes	N/A	1	None	N/A



## First Class Amenities

The Galaxy FBO will offer world-class amenities for passengers to unwind in comfortable surroundings:

- Arrival-Departure canopy.
- Dedicated concierge services, spacious lounge area.
- Flight planning rooms with weather services.
- Work stations and private meeting rooms with audio/video conferencing capabilities.
- Black Walnut Café, a contemporary fast casual, American restaurant to offer all-day dining experience with a view of the runway.
- Covered parking and professional car detailing.







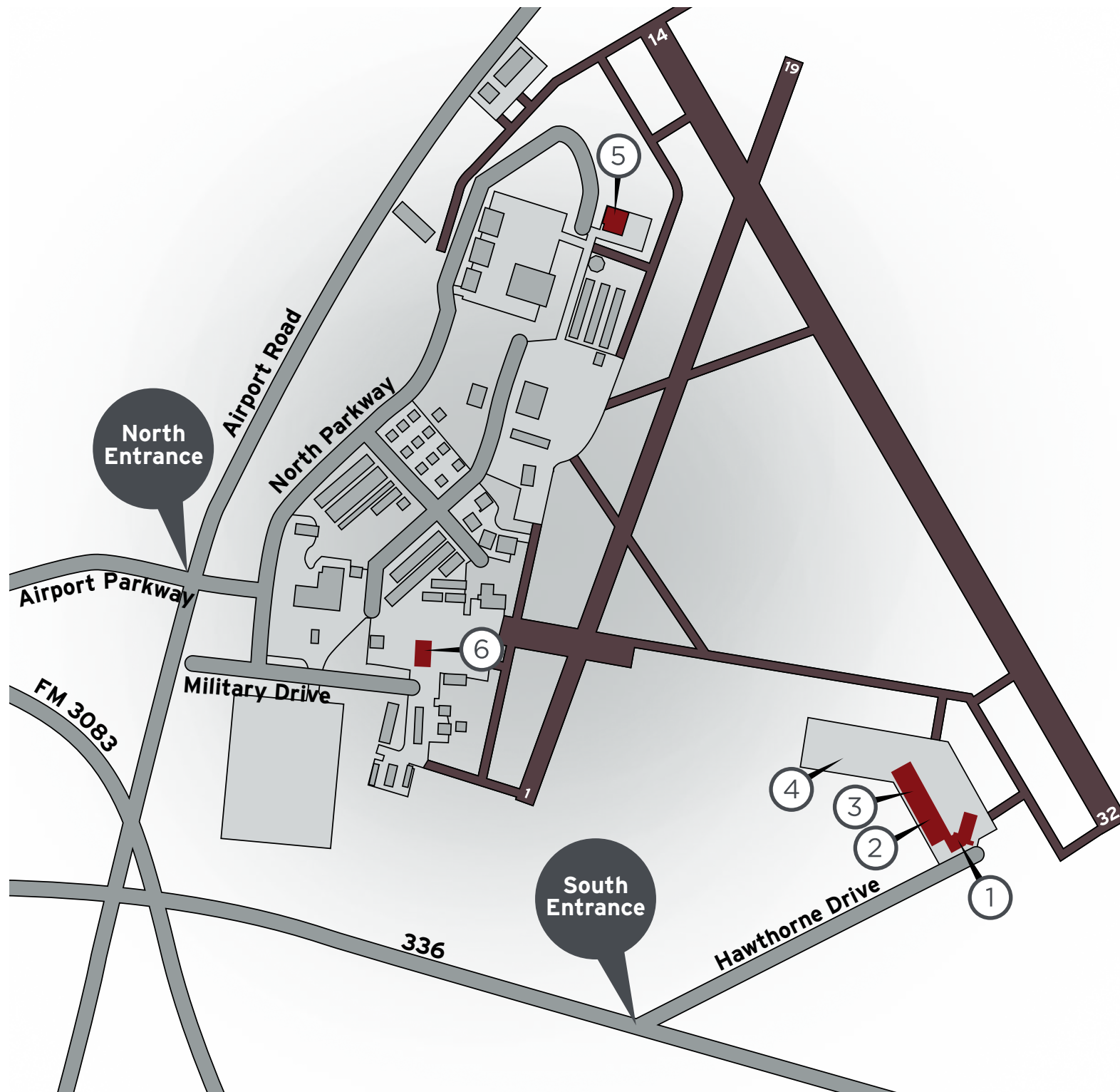

## Available Hangar & Office Space

- ① S10 - Galaxy FBO Building: 15,000 sq.ft. available Class-A office space.
- ② S11 - Galaxy FBO Hangar: space available for business jets.
- ③ S12 - Corporate Hangar: 38,000 sq.ft. hangar space and 12,000 sq.ft. storage space available for a single tenant / corporate flight department.
- ④ Available build-to-suit hangar space.
- ⑤ Hangar 10: 15,000 sq.ft. hangar space, plus office and space, with private ramp, available for a single tenant / corporate flight department.
- ⑥ Hangar 25: 12,000 sq.ft. hangar space for turboprop / piston aircraft storage, and 4,000 sq.ft. office space.







## S12 Corporate Hangar

- 124 ft. by 294 ft.; 38,000 sq.ft hangar space with 32 ft. clearance.
- 12,000 sq.ft. office space, storage and covered parking behind the hangar.
- Up to 15,000 sq.ft. Additional Class-A office space available in adjacent building.

For more information:  
[hangar@galaxyfbo.com](mailto:hangar@galaxyfbo.com)  
(936) 494-4252

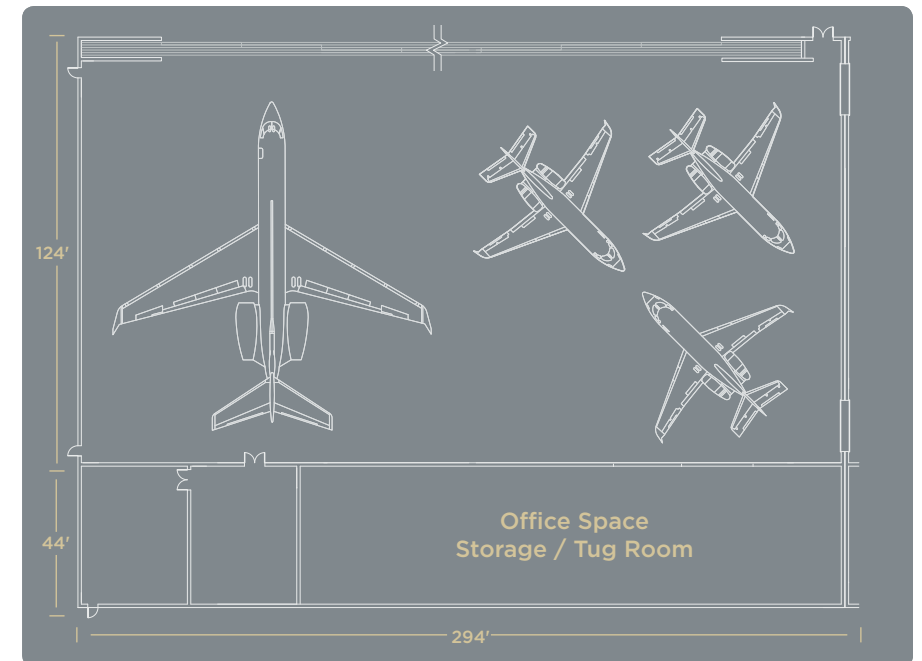

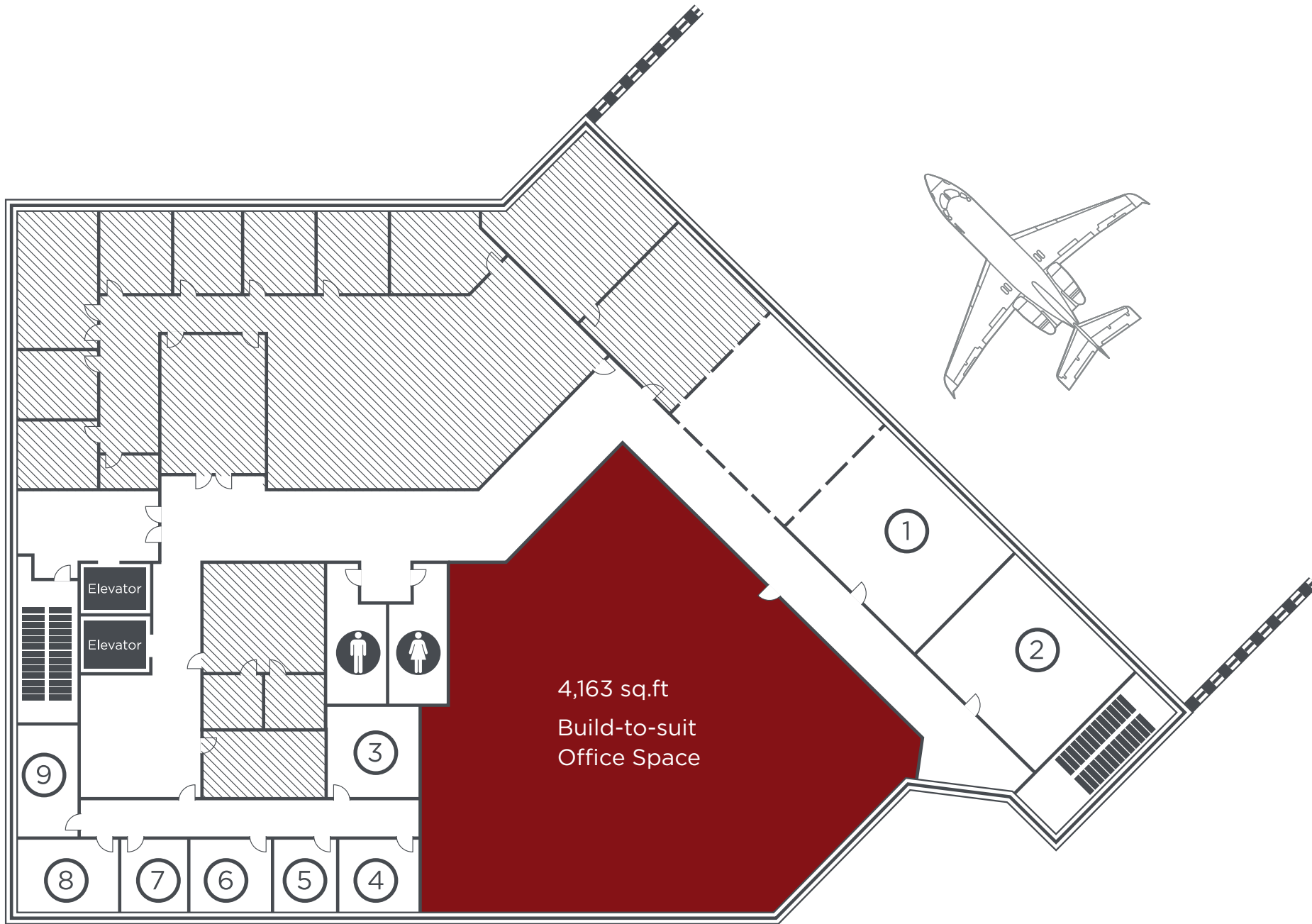

## Available Business Suites

- Available as furnished, with high speed internet and phone system.
- Access to conference rooms and other amenities.

- ① 23 ft. by 29 ft.
- ② 23 ft. by 27 ft.
- ③ 15 ft. by 15 ft.
- ④ 12 ft. by 13 ft.
- ⑤ 12 ft. by 10 ft.
- ⑥ 12 ft. by 13 ft.
- ⑦ 12 ft. by 11 ft.
- ⑧ 12 ft. by 17 ft.
- ⑨ 10 ft. by 18 ft.

For more information:  
[hangar@galaxyfbo.com](mailto:hangar@galaxyfbo.com)  
 (936) 494-4252







Galaxy FBO  
Lone Star Executive Airport KCXO  
2971 Hawthorne Drive  
Conroe, TX 77303

[www.galaxyfbo.com](http://www.galaxyfbo.com) | phone (936) 494-4252

GFB0.MTS102013.V40b